

For doors on escape routes

- The features of this panic device are of utmost importance for people's safety. Therefore in no case may any changes be made to the product.



www.strandhardware.co.uk/images/PDF/DoPDFineTouchBar.pdf

Declaration Of Performance (CE)



https://www.strandhardware.co.uk/images/UKCA-DOPs/UKCA_Panic_Hardware_SHWUKCA6.pdf

Declaration Of Performance (UKCA)

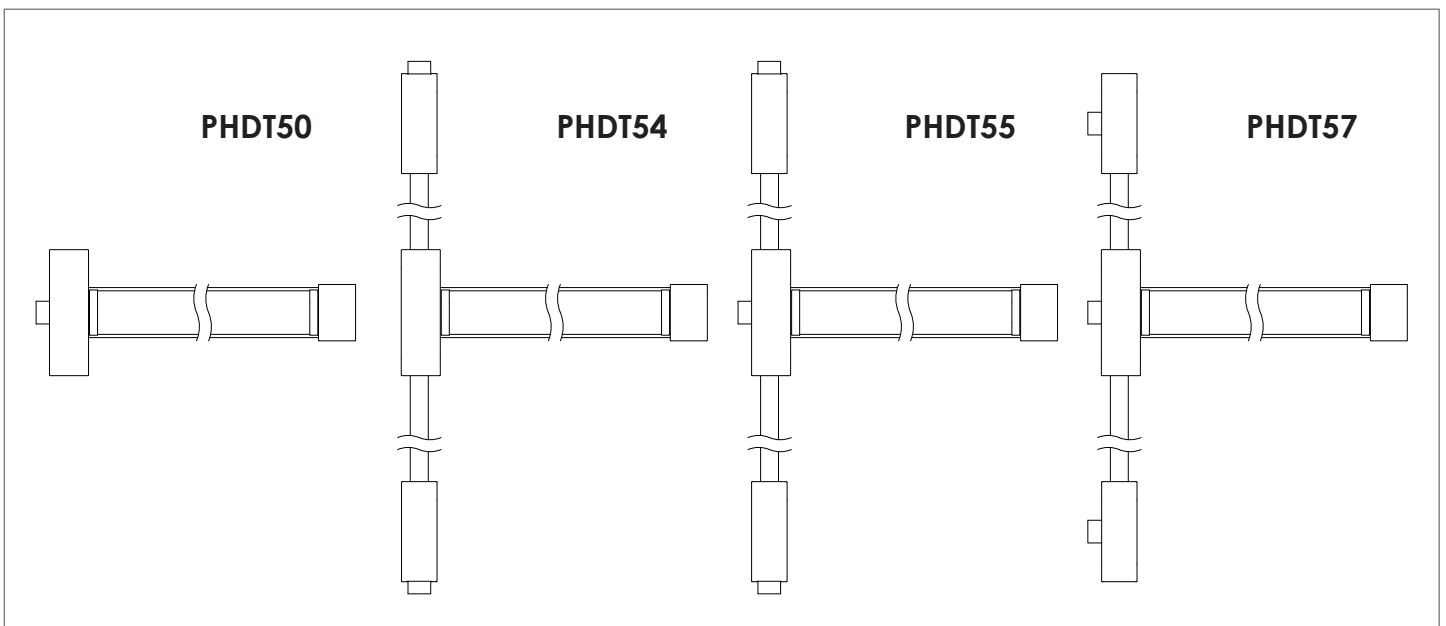

Machining the profile

- After completing work on the profile, fasten the push bar in place using V3 screws provided (8 self-tapping screw, Ø 3,9mm. Drill a Ø 3,0 mm. hole.)

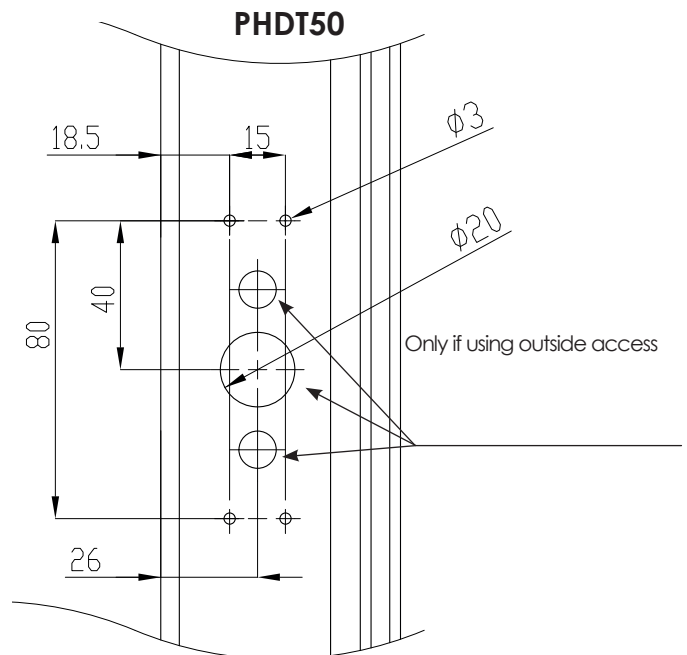



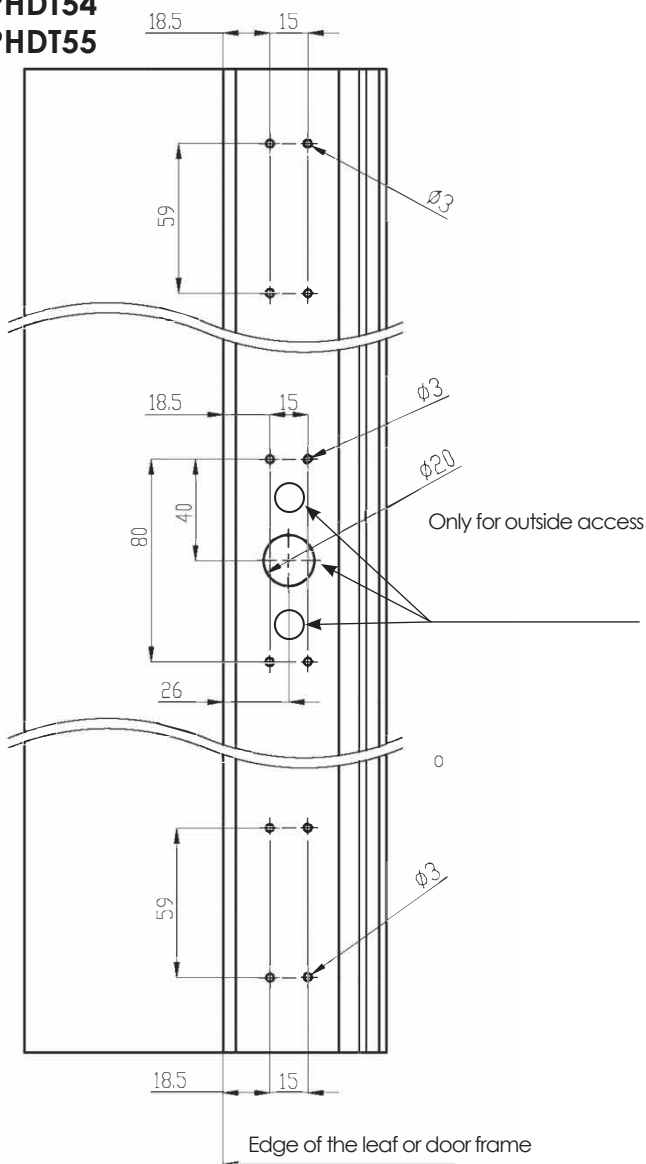

- After completing work on the profile, fasten the push bar in place using V3 screws provided (16 self-tapping screw, \varnothing 3,9mm. Drill a \varnothing 3,0 mm. hole.)

**PHDT54
PHDT55**

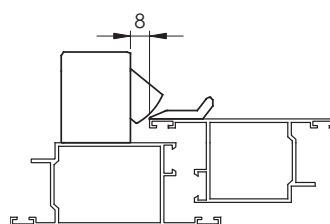
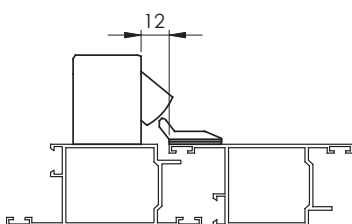
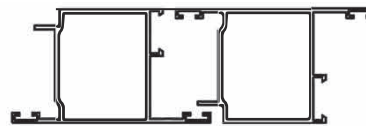
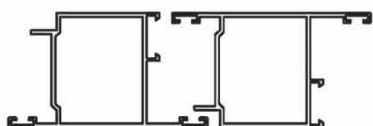
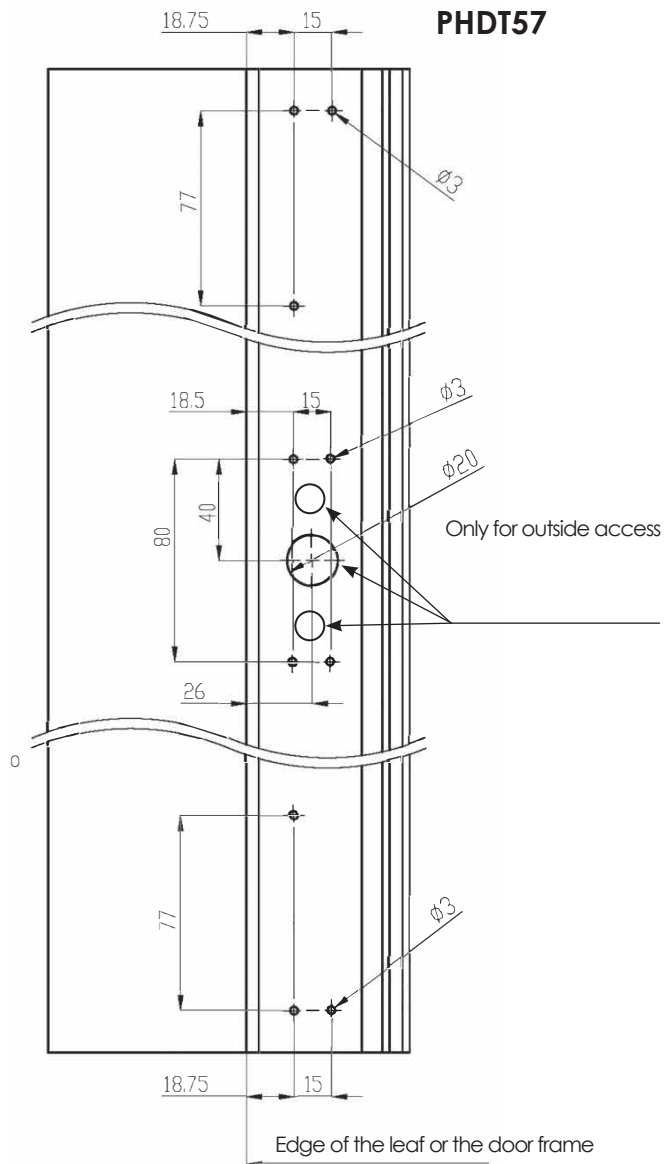

PHDT57

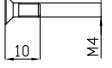

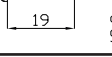
Fixing screws			
V1	3	 Torx T20	
V2	6		

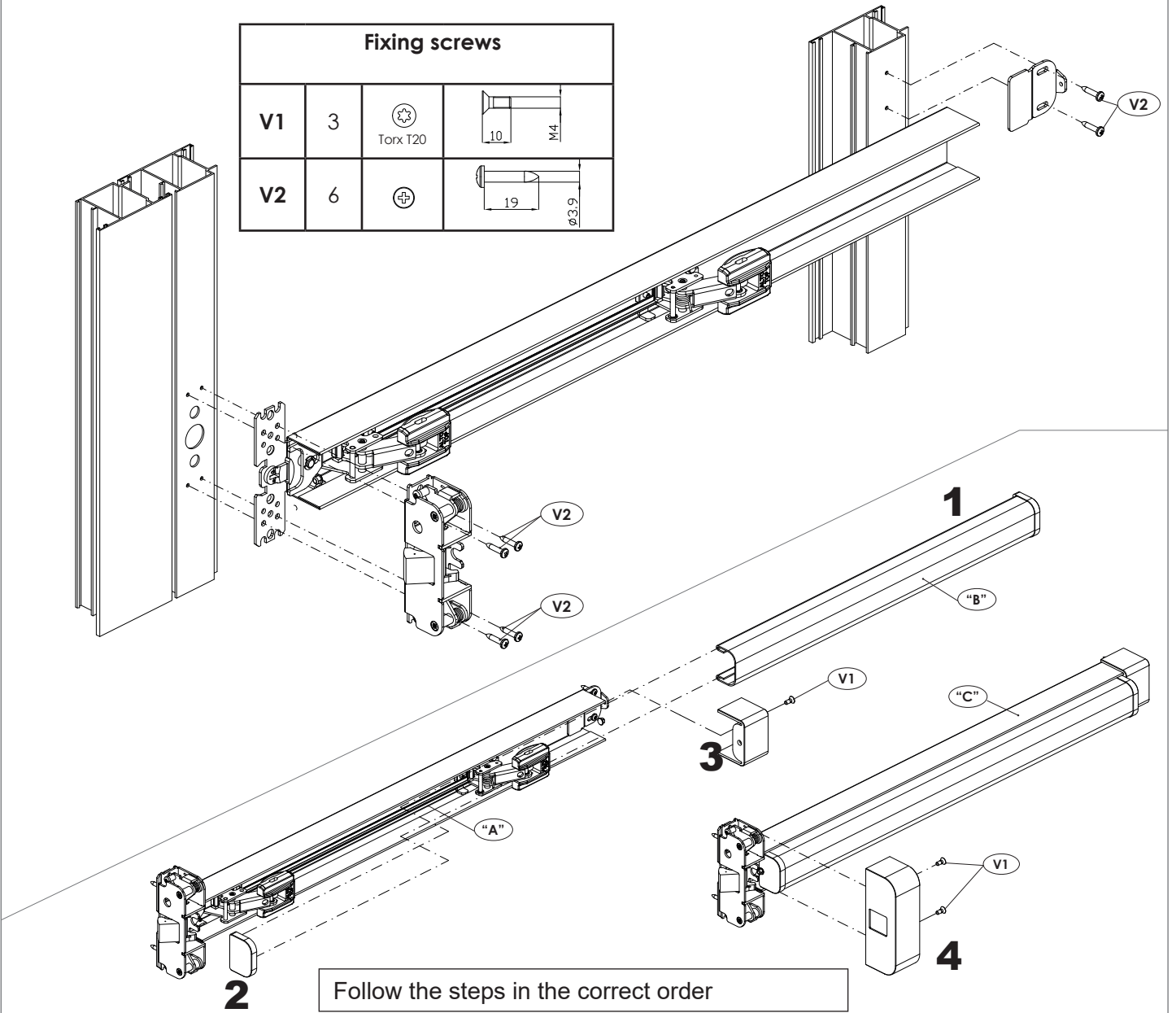

To reduce bar length

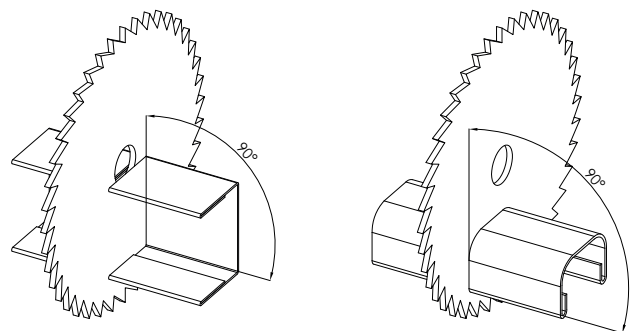
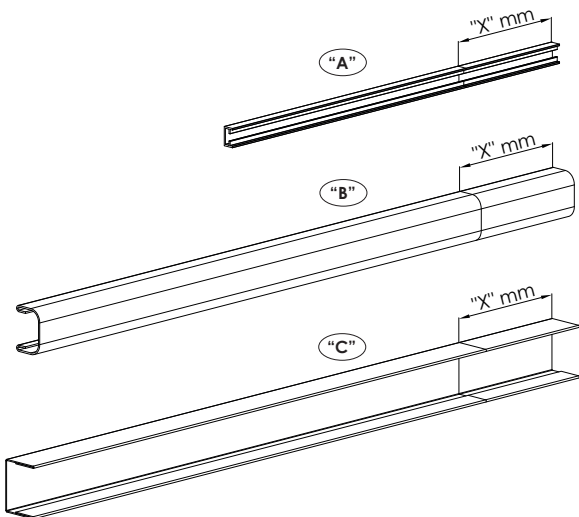

ATTENZIONE:

- Ensure all three bars are reduced by the same amount
- Use blade designed to cut stainless steel
- Cut at 90 degrees exactly

**PHDT54
PHDT55**

PHDT57

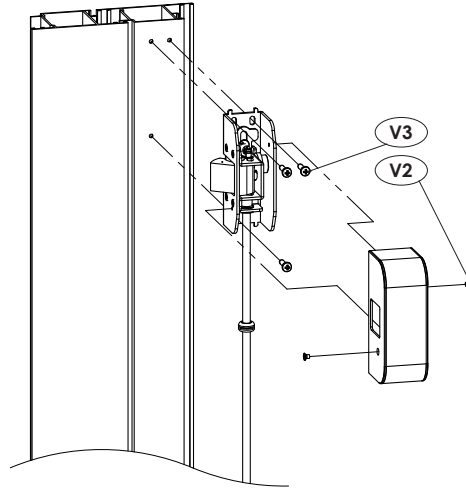
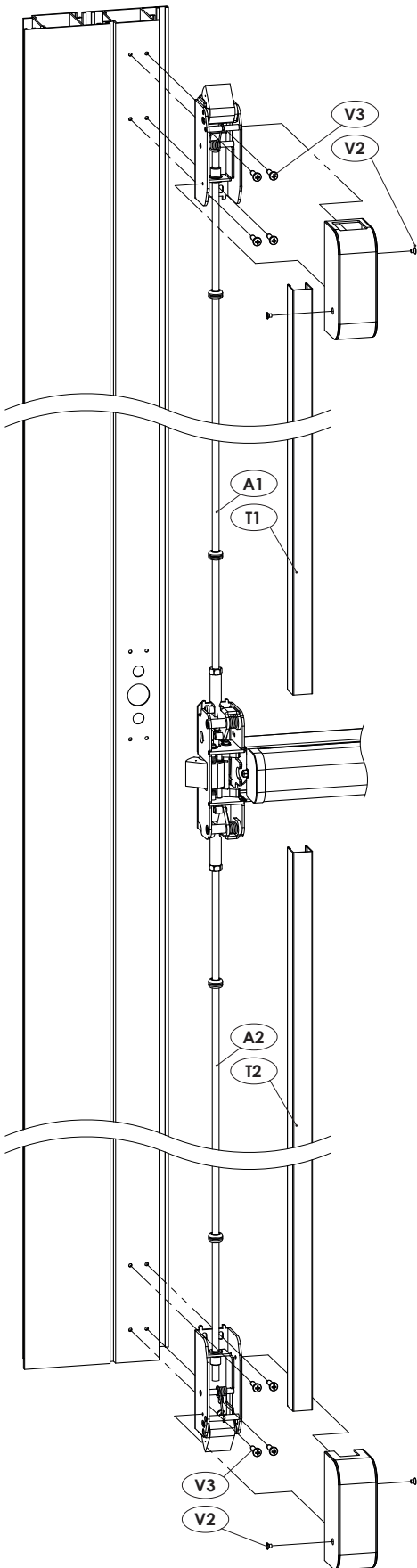
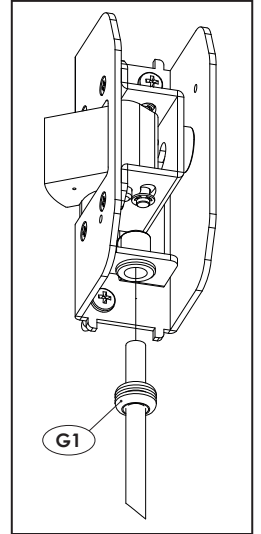

Fixing screws			
Fixing screws	Horizontal		Vertical
	Horizontal	Vertical	
V2	4	4	 10 N4
V3	6	8	 19 $\varnothing 3.9$
D1	2	2	
G1	4	4	

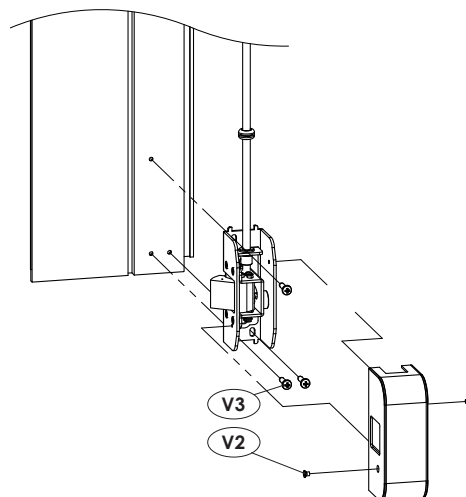
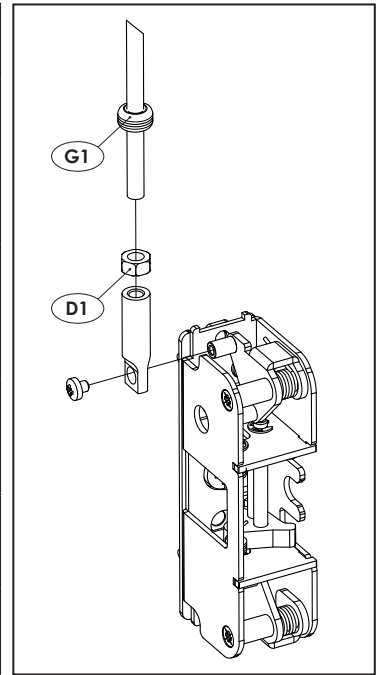

Threaded rod

Rod Covers

